

A R C U S

PRO-IL LED LUMINAIRES

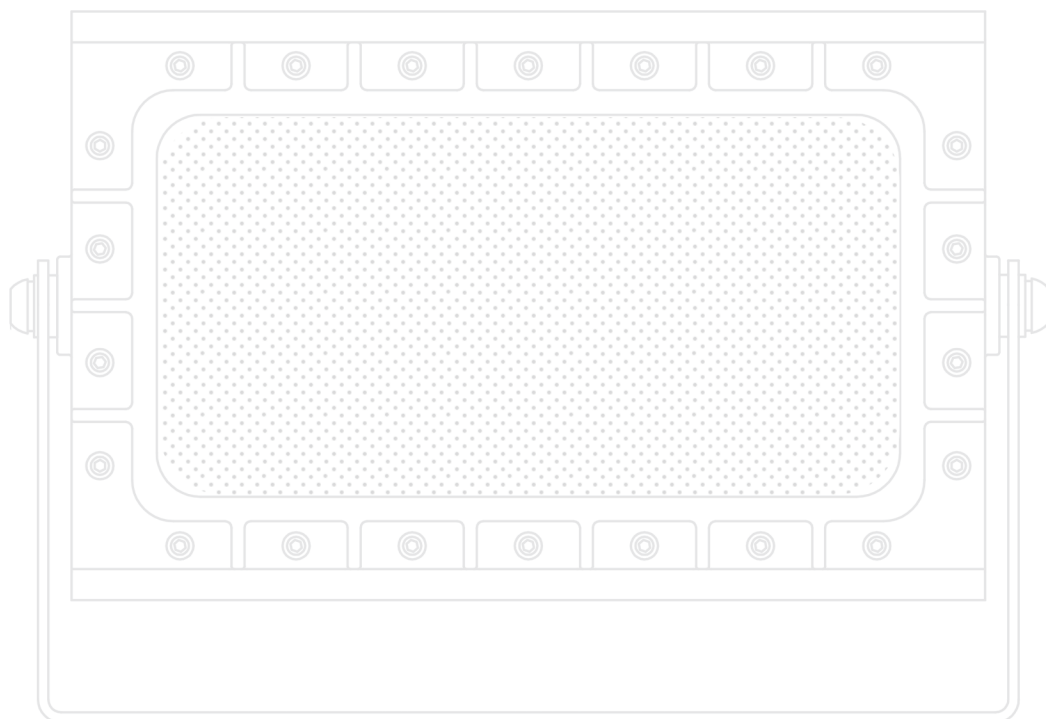

PROAIR™ FOR EX



COMING SOON

EXPLOSION PROOF



PROAIR™ FOR HL



HAZARDOUS LOCATION



PROAIR™ FOR IL



INDUSTRIAL LOCATION





SPECIFICATION

MODEL WATTAGE	60W	80W	100W	120W
LUMEN OUTPUT	7800 LM*	9900 LM*	12000 LM*	13000 LM*
DIMENSIONS	13.9 X 9.0 X 3.8 IN (354 X 228 X 96 MM)		13.9 X 10.7 X 3.8 IN (354 X 272 X 96 MM)	
NET FIXTURE WEIGHT (with SB swivel bracket)	15.4 LBS (7.6 KG)		19.9 LBS (9.6 KG)	
ENCLOSURE MATERIAL	Copper free aluminum alloy			
FINISH	Polyester powder coat finish			
HARDWARE AND MOUNTING	Marine grade stainless steel parts and screws			
CABLE GLANDS AND CONNECTORS	Stainless steel cable gland with 6 feet of wire			
LENS	Military Grade UL94 V-0 rated Lexan and engineered optics			
LIGHT SOURCE	High Power CREE LEDs			
COLOR RENDITION INDEX (CRI)	> 70			
INPUT POWER (+25°C)	60W	80W	100W	120W
FIXTURE EFFICIENCY	130 LPV	123 LPW	120 LPW	108 LPW
LED DRIVER	Phillips Xitanium, 120-277 VAC, 50/60Hz; With 0-10 VDC Dimming			
LED DRIVER PROTECTION	Short Circuit, Open Circuit Protection for LED + and LED – and Temperature Foldback			
SURGE PROTECTION	6kV exept LV			
POWER FACTOR	> 0.95			
THD (total harmonic distortion)	<10%			
INRUSH CURRENT	23-51.5 A	27-84 A	27-84 A	46-103 A
AMBIENT OPERATING TEMPERATURE	-40°C TO +45°C (IL) -40°C TO +55°C (ILL)	-40°C TO +40°C (IL) -40°C TO +55°C (ILL)	-40°C TO +55°C	-40°C TO +50°C
FIXTURE LIFE (+25°C)	100 000 hours	100 000 hours	100 000 hours	100 000 HOURS
FIXTURE LIFE (+55°C)	50 000 hours (ILL)	50 000 hours (ILL)	50 000 hours	N/A
FIXTURE LIFE (+65°C)	N/A	N/A	N/A	N/A
ACCESSORIES (ORDER SEPARATELY)	Slip-fitter, Bullhorns, PhotoCell			
WARRANTY	5 Years			

* - Measurement tolerance +/- 10%

ETL/cETL CERTIFIED TO:

UL 1598 Suitable for Wet Locations
UL 1598A Marine Outside Type
(Saltwater)
UL 844 for Use in Hazardous
(Classified) Locations
CSA C22.2 No. 250.0
CSA C22.2 No. 137
IP66 rated per IEC 60598-1 |
-40°C to +45°C

APPROVED FOR:

IP67
Dust proof, water resistant, high
temperature and sub zero applications
Corrosive atmospheres, marine rated,
extreme wet applications

ARCUS PRO-HL LED BENEFITS:

- Instant illumination and restrike
- Versatile mounting options
- Extremely lightweight vs competition
- Energy-efficient/up to 65% savings when compared to traditional HID lighting
- 0-10V dimming for controls
- Damn near bullet proof
- Up to 23 years (at 12hrs a day) of light, eliminating bulb and ballast replacement maintenance
- Contains no mercury or other hazardous substances
- High CRI for improved visibility and clarity
- Operating ambient -40°C to +55°C
- 5 year fixture warranty

APPLICATION

Exterior flood, spot
Wet, Dusty interior and exterior applications
Locations requiring continuous and consistent light levels in extreme heat or cold.
Highbay Applications
Marine, boats, ships
Manufacturing
Wastewater



ORDERING INFORMATION: PART NUMBER EXAMPLE PRO-IL-SB-PPC-RV-120-5K-60W-S

1 PRO

2 IL

3 SBP

4 PPC

5 RV

6 120

7 5K

8 60W

9 S

DETAILED INFORMATION

<div>2</div> <div>FAMILY NAME ENCLOSURE TYPE</div> <div>HL Industrial Locations Rated Flat Enclosure</div> <div>HLL Industrial Locations Rated Curved Fin Enclosure</div>	<div>3</div> <div>MOUNTING</div> <div>SBP Swivel Bracket Pendant Mount (Standard)</div>	<div>4</div> <div>REFLECTOR</div> <div>PPC Protective Polycarbonate</div>	<div>5</div> <div>VOLTAGE</div> <div>RV 120-277 VAC (with dimming option)</div> <div>LV Low voltage 24 VDC*</div>
<div>6</div> <div>SECONDARY OPTICS</div> <div>120° Full Flood (No Optics - Standard)</div> <div>85° NEMA6 Type Beam (Round)</div>	<div>7</div> <div>COLOR TEMPERATURE</div> <div>3K 3000K Warm Yellow</div> <div>4K 4000K Warm White</div> <div>5K 5000K Cool White (Standard)</div>	<div>8</div> <div>WATTAGE</div> <div>60W</div> <div>80W</div> <div>100W</div> <div>120W</div>	<div>9</div> <div>BODY COLOR</div> <div>S Silver (Standard)</div> <div>* only available for 60 W</div>

PROJECT INFORMATION

PROJECT NAME:

LOCATION:

DESCRIPTION:

CONTACT INFORMATION:

NAME:

E-MAIL:

PHONE:

DATE:

PRO-IL (SBP BRACKET)

FIXTURE WEIGHT:
17,6 lb (7,98 kg)

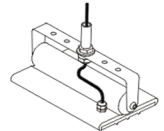
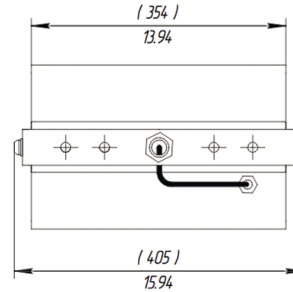
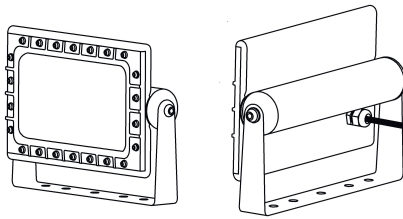
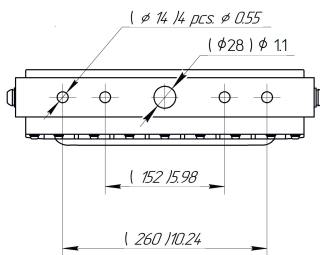
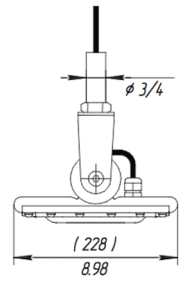
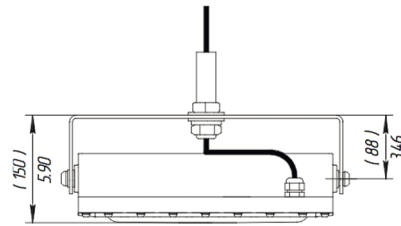
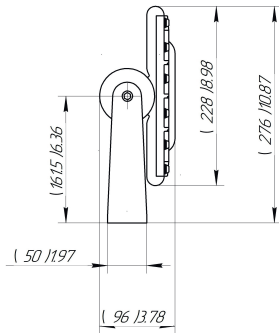
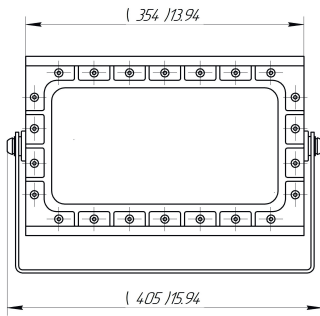



(858) 353-1073

SALES@ARCUSLIGHT.COM

10457 ROSELLE STREET, SUITE #E
SAN DIEGO, CA 92121