

A R C U S

**Oppry™ Family**

---

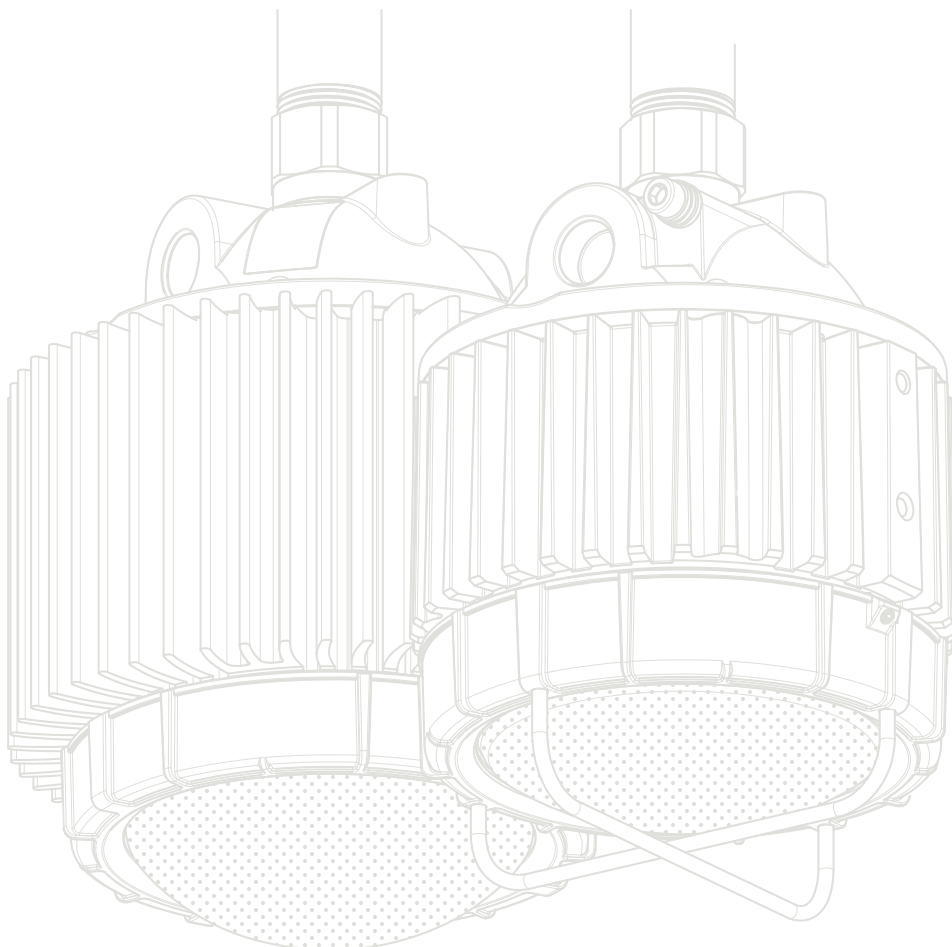

## APPLICATION

Oppry™ LED luminaire for Low Bay and Area illumination is designed for indoor and outdoor industrial ordinary and hazardous locations including wet locations and marine environment.

It has unique design that combines cutting-edge technology development in both lighting and industrial safety. The luminaire features optics that provides efficient lighting pattern, heat-sinking optimization that provides long life and energy efficient OSRAM LED's that allow low energy consumption.

## MODELS ARE SUITABLE FOR USE IN THE FOLLOWING LOCATIONS:

- Use in Hazardous (Classified) Location only as per 844 UL
- Dry and Wet Locations as per UL 1598
- Outdoor Type (Salt Water as per UL1598A)



**NOTE (!):** This product must be installed in accordance with the applicable installation code by a person familiar with the construction and operation of the product and the hazards involved

## WARNING

- 1 To avoid the risk of fire, explosion, or electric shock, this product should be installed, inspected, and maintained by a qualified electrician only, in accordance with all applicable electrical codes.
- 2 To avoid electric shock:
  - A. Be certain electrical power is OFF before and during installation and maintenance.
  - B. Luminaire must be supplied by a wiring system with an equipment-grounding conductor.
- 3 To avoid explosion:
  - A. Make sure that the supply voltage is the same as the luminaire voltage.
  - B. Do not install where the marked operating temperatures exceed the ignition temperature of the hazardous atmosphere.
  - C. Do not operate in ambient temperatures above those indicated on the luminaire nameplate.
  - D. All gasket seals must be clean and undamaged.
  - E. Use proper supply wiring as specified on the luminaire nameplate.
  - F. Before dismounting, electrical power to the luminaire must be turned off, keep tightly closed when in operation.

**READ ALL INSTRUCTIONS CAREFULLY BEFORE BEGINNING THE INSTALLATION!**

## Oppry™ family tree

### QUICK-DISCONNECTION MOUNTING ACCESSORIES

#### PMB

one hub for 3/4 NPT

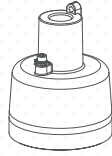

#### SAB

one hub for 1-1/2 NPT

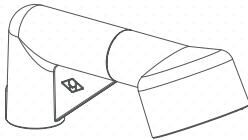

#### SSB

one hub for 1-1/2 NPT

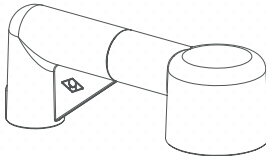

#### WAB

three plugs,  
one hub for 3/4 NPT

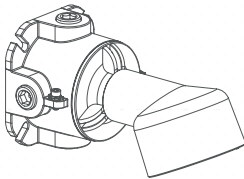

#### WMB

three plugs,  
one hub for 3/4 NPT

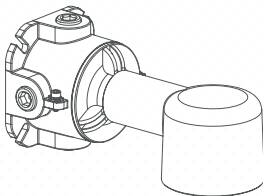

#### CMB

three plugs,  
one hub for 3/4 NPT

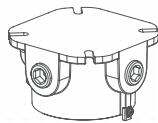

#### EMB

one hub for 3/4 NPT



#### SBB

one plug,  
one hub for 3/4 NPT

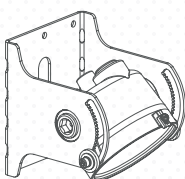

36 W

60 W

### STANDARD MOUNTING ACCESSORIES

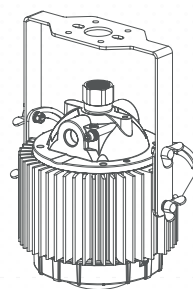
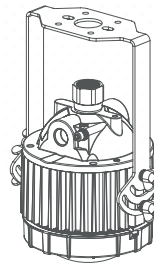

**SB**  
Swivel  
Bracket

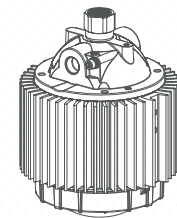
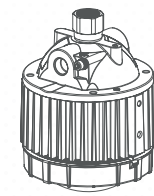

**PM**  
Pendant  
Mount

### DIFFUSERS

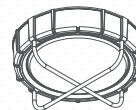

**GM**  
Borosilicate glass  
and mesh guard

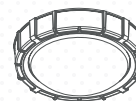

**XPC**  
Extreme  
polycarbonate lens

## INSTALLATION OF STANDARD MOUNTING ACCESSORIES

1. When installing the luminaire with an SB-type mounting bracket, first attach the fixture using the swivel bracket (SB) to the cable conduit or any other mounting surface of choice according to Fig. 2, using two sets of screws, washers, and nuts.

If the mounting surface allows, self-tapping screws or lag bolts can also be used.

For ease of installation, rotate the luminaire to the extreme position on the bracket by loosening the securing screws beforehand (see Fig. 1).

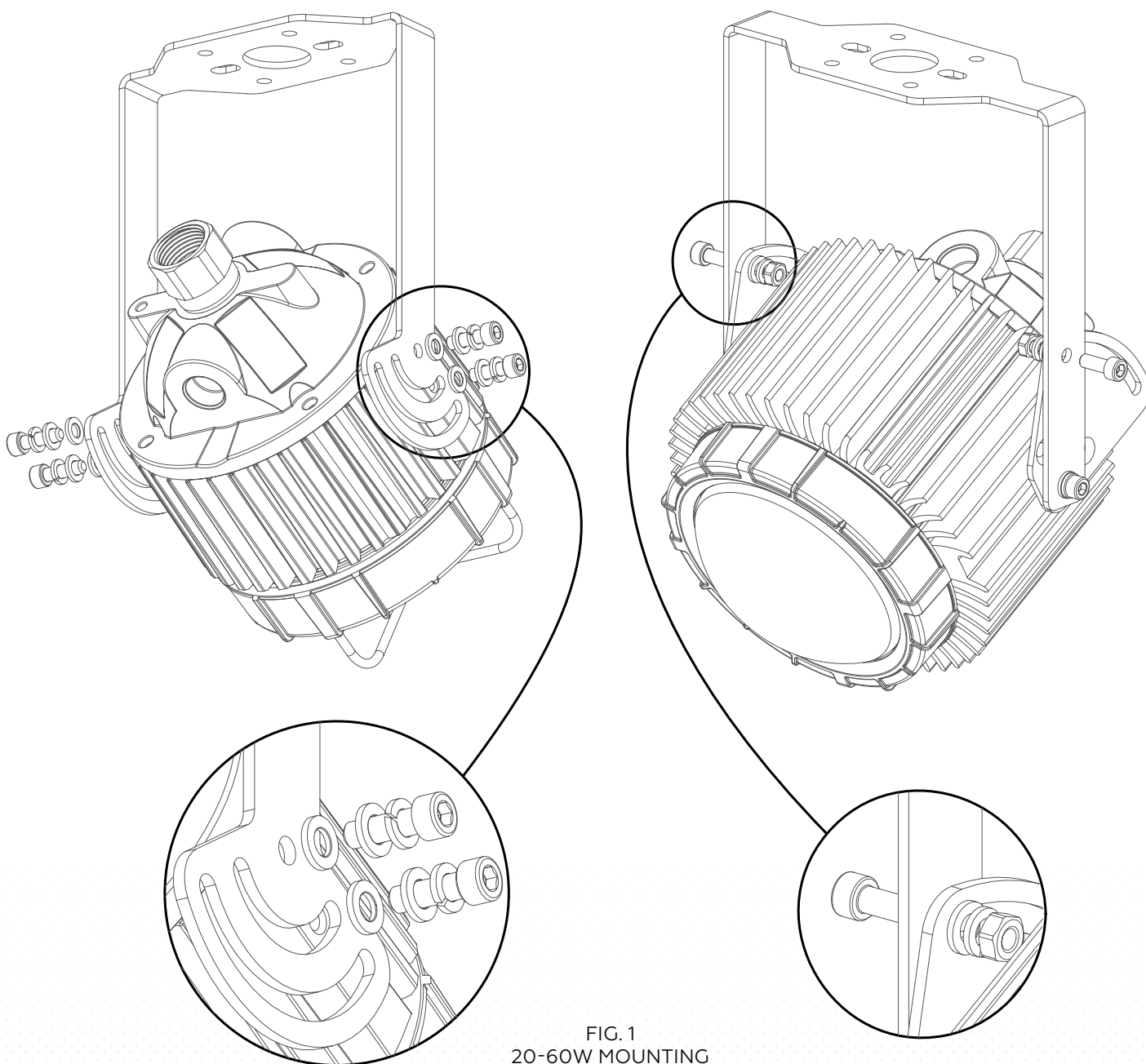

FIG. 1  
20-60W MOUNTING

**TO PREVENT THREAD GALLING, LIGHTLY LUBRICATE ALL MOUNTING THREADS!**

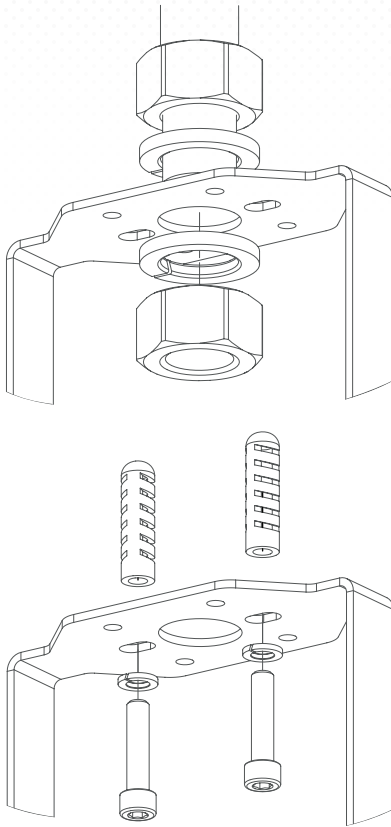

FIG. 2

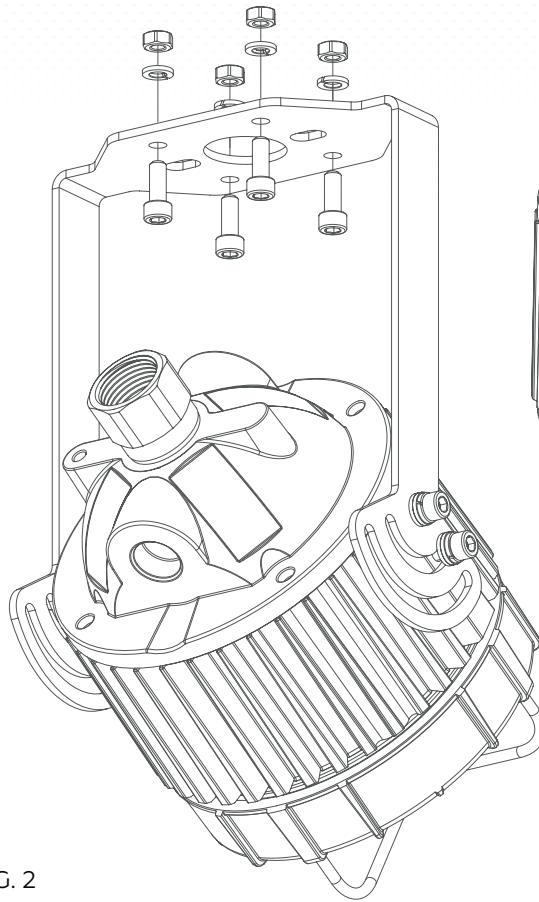

FIG. 3

## CABLE CONNECTION

**NOTE (!):** The following steps use the 36W luminaire as an example (SB mounting bracket not shown) and are also applicable to suspended mounting (PM type) and 60W luminaires.

2. Unscrew the set screw (see Fig. 3).
3. Unscrew the fixture lid along with the gasket and separate it from the fixture body (see Fig. 4).
4. The Oppry™ (terminal unit with one cable entry) luminaire is supplied with one pre-installed M20 to NPT adapter.
5. Prepare appropriate size cable wires for connection to the fixture terminals by stripping back few millimeters of each wire sheath to suite the terminal geometry.

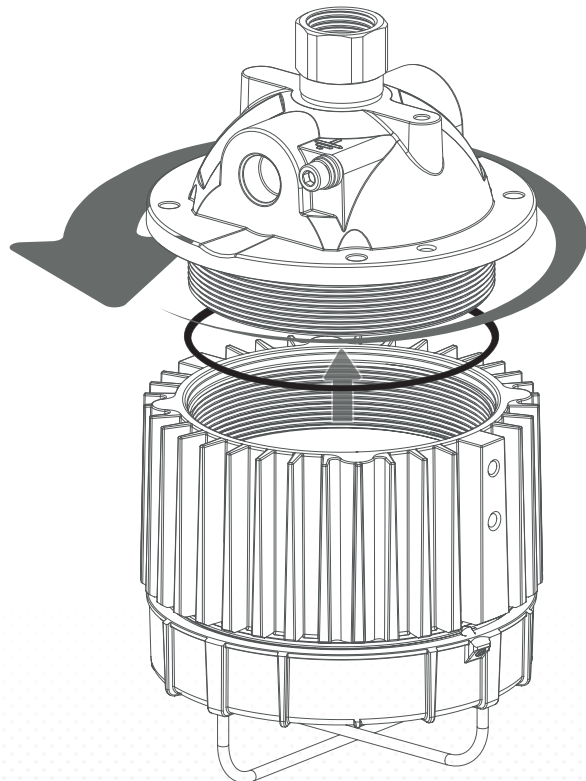

FIG. 4



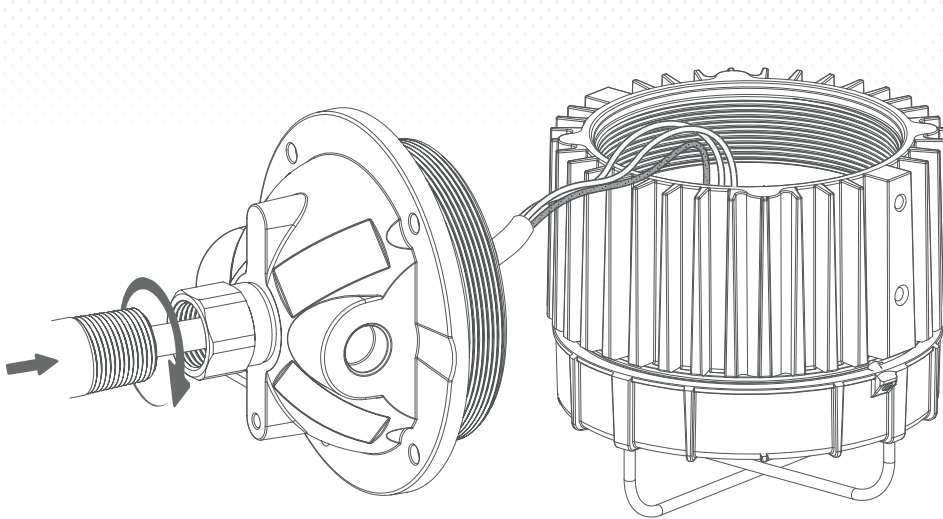

FIG. 5

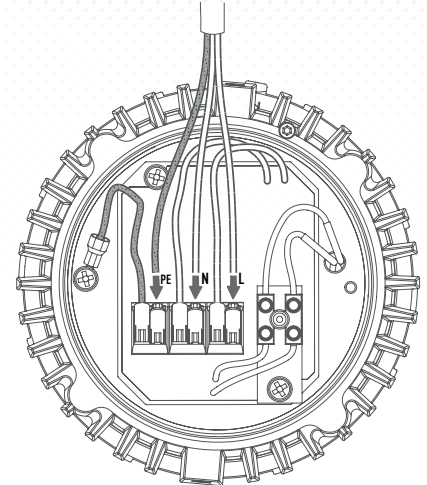

FIG. 6

6. Install the appropriate cable gland or conduit into the fixture lid through the NPT adapter, routing the cable through the cable gland into the interior of the lid (see Fig. 5).
7. Connect power cable and neutral wires to terminal (4). Power cable to L and neutral to N, correspondingly and internal ground wire to grounding, (see Fig. 6).

8. Insert the gasket into the dedicated groove on the fixture lid. Before installing the lid, inspect the gasket for any damage and replace it if necessary. Join the fixture lid and fixture body (see Fig. 7).

**NOTE (!):** Ensure that all components—adapter, sealing nut, cable clamps — are securely tightened.

9. Install and tighten set screw. See Fig. 8
10. The fixture is ready to be used.

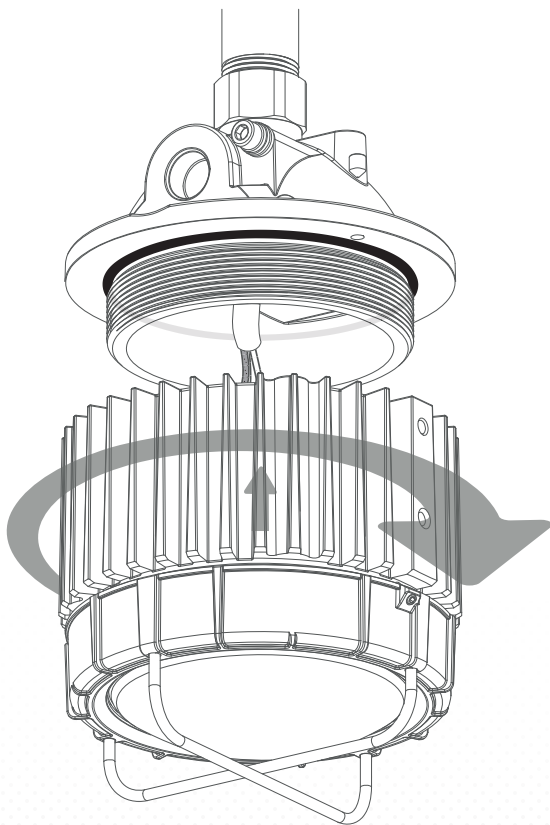

FIG. 7

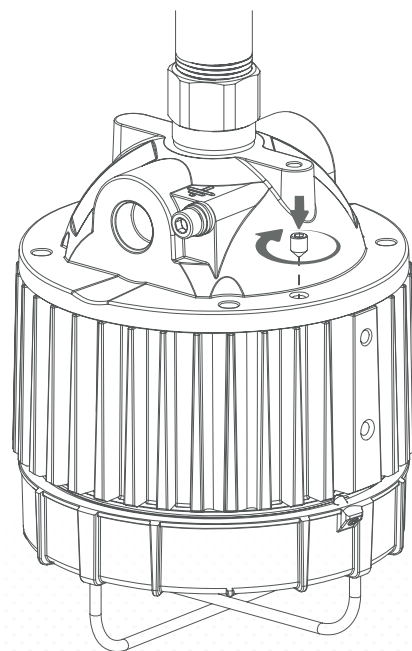

FIG. 8

## INSTALLATION OF QUICK-DISCONNECTION MOUNTING ACCESSORIES

### PMB MOUNTING MODULE INSTALLATION:

(See Figure 9, 10, 11) (Hub mounting thread is 3/4 NPT)

1. Remove the top module of quick-disconnection coupling from the suspended bracket by loosening two screws.
2. Pull field wiring into the suspended bracket.
3. Apply a small amount of lubricant to the suspended bracket metric thread.
4. Mount the suspended bracket on the conduit.
5. Tighten conduit set screw.
6. Attach circuit GREEN ground wire to ground screw connection B inside the suspended bracket and then attach outer GREEN ground wire to ground screw connection A outside the suspended bracket.
7. Attach ungrounded primary supply wire to connection terminal, which attached to BLACK wire, other supply wire to connection terminal, which attached to WHITE wire.
8. Attach POSITIVE diming wire to connection terminal, which marked with red label, and NEGATIVE diming wire to connection terminal, which marked with blue label. (If you need this function).
9. Tighten all electrical connections securely.
10. Insert top module of quick-disconnection coupling into the suspended bracket, and install the two connection screws.
11. Apply a small amount of lubricant to the luminaire metric thread.
12. Thread luminaire assembly completely into the suspended bracket.
13. Lock luminaire with locking pin, tighten set screw.

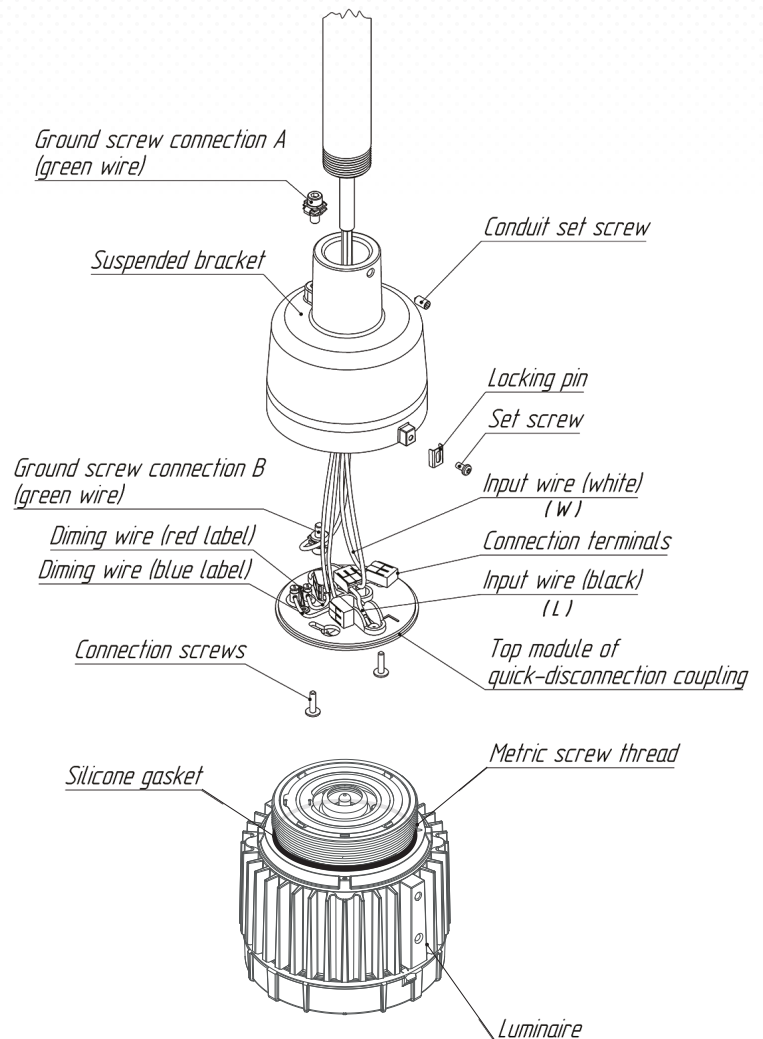

PM MOUNTING MODULE  
FIG. 9

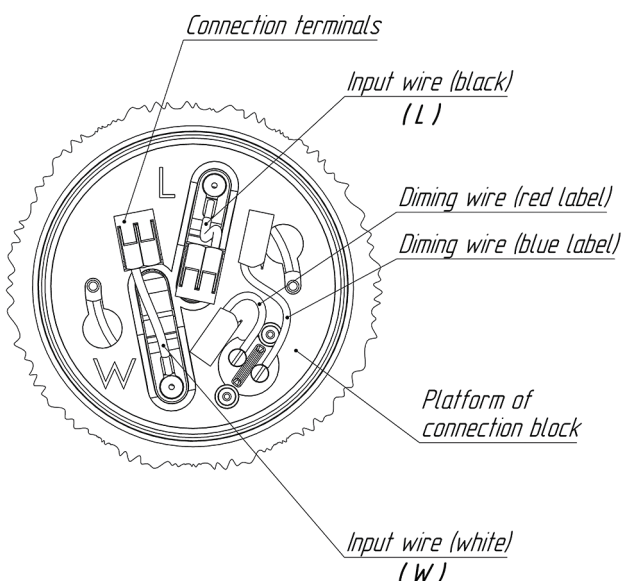

TOP MODULE OF QUICK-DISCONNECTION COUPLING  
FIG. 10

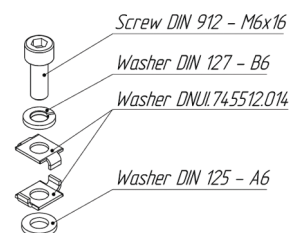

GROUND SCREW CONNECTION  
FIG. 11

## SAB AND SSB MOUNTING MODULE INSTALLATION:

(See Figure 12 and 9, 10, 11) (Hub mounting thread is 1-1/2 NPT)

1. Remove the top module of quick-disconnection coupling from the curved bracket-115 (for SAB module) or curved bracket-90 (for SSB module) by loosening two connection screws.
2. Pull field wiring into the curved bracket.
3. Apply a small amount of lubricant to the curved bracket threads.
4. Mount curved bracket on the conduit.
5. Tighten conduit set screw.
6. Pull field wiring into the curved bracket-115 (for SAB module) or curved bracket-90 (for SSB module).
7. Thread curved bracket-115 assembly completely on the curved bracket.
8. Lock connection with locking pin A, tighten set screw A.
9. Attach circuit GREEN ground wire to ground screw connection into the curved bracket-115 (for SAB module) or curved bracket-90 (for SSB module).
10. Attach ungrounded primary supply wire to connection terminal, which attached to BLACK wire, other supply wire to connection terminal, which attached to WHITE wire.
11. Attach POSITIVE diming wire to connection terminal, which marked with red label, and NEGATIVE diming wire to connection terminal, which marked with blue label. (If you need this function).
12. Tighten all electrical connections securely.
13. Insert top module of quick-disconnection coupling into the curved bracket-115 (for SAB module) or curved bracket-90 (for SSB module) and install the two connection screws.
14. Apply a small amount of lubricant to the luminaire metric thread.
15. Thread luminaire assembly completely into the curved bracket-115 (for SAB module) or curved bracket-90 (for SSB module).
16. Lock luminaire with locking pin B, tighten set screw B.

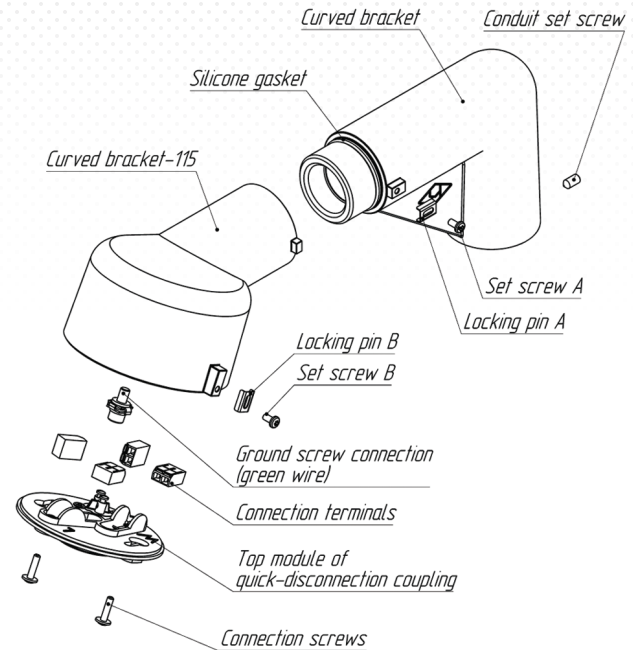

SAB MOUNTING MODULE  
FIG. 12

## WAB AND WMB MOUNTING MODULE INSTALLATION:

(See Figure 13 and 9, 10, 11) (Wall mounting)

1. Use connection box as a template, mark and drill desired location on mounting surface.
2. Secure connection box to surface using M8 bolts or lag screws (not provided).
3. Remove the necessary recessed plugs from connection box, by using hex key 14 mm, 0,55".
4. Pull field wiring into the connection box.
5. Attach circuit GREEN ground wire to ground screw connection B inside the connection box and then attach outer GREEN ground wire to ground screw connection A outside the connection box.
6. Remove the top module of quick-disconnection coupling from the curved bracket-115 (for WAB module) or curved bracket-90 (for WMB module) by loosening two screws.
7. Attach ungrounded primary supply wire to connection terminal, which attached to BLACK wire, other supply wire to connection terminal, which attached to WHITE wire.
8. Attach Positive diming wire to connection terminal, which marked with red label, and Negative diming wire to connection terminal, which marked with blue label. (If you need this function).
9. Tighten all electrical connections securely.
10. Apply a small amount of lubricant to the connection box thread.
11. Thread Adapter with curved bracket assembly completely into the connection box.
12. Lock connection with locking pin A, tighten set screw A.
13. Rotate the top module of quick-disconnection coupling to correct the wires.
14. Insert top module of quick-disconnection coupling into the curved bracket-115 (for WAB module) or curved bracket-90 (for WMB module) and install the two connection screws.
15. Apply a small amount of lubricant to the luminaire metric thread.
16. Thread luminaire assembly completely into the curved bracket-115 (for WAB module) or curved bracket-90 (for WMB module).
17. Lock mounting module with locking pin B, tighten set screw B.

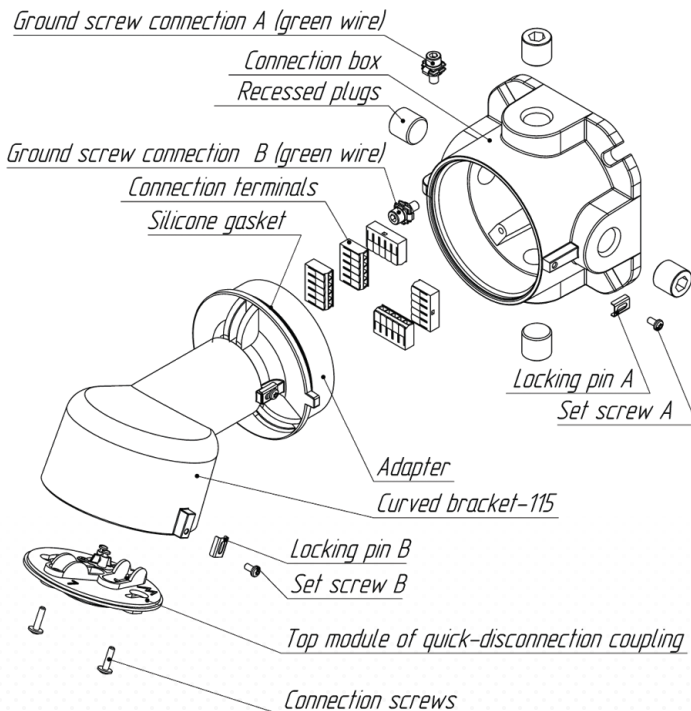

WAB MOUNTING MODULE  
FIG. 13



## CMB MOUNTING MODULE INSTALLATION:

(See Figure 14 and 9, 10, 11) (Wall mounting)

1. Use CMB mounting module as a template, mark and drill desired location on mounting surface.
2. Secure CMB mounting module to surface using M8 bolts or lag screws (not provided).
3. Remove the necessary recessed plugs from CMB mounting module, by using hex key 14 mm, 0,55".
4. Remove the top module of quick-disconnection coupling from the connection box by loosening two screws.
5. Pull field wiring into the connection box.
6. Attach circuit GREEN ground wire to ground screw connection B inside the connection box and then attach outer GREEN ground wire to ground screw connection A outside the connection box.
7. Attach ungrounded primary supply wire to connection terminal, which attached to BLACK wire, other supply wire to connection terminal, which attached to WHITE wire.
8. Attach POSITIVE diming wire to connection terminal, which marked with red label, and NEGATIVE diming wire to connection terminal, which marked with blue label. (If you need this function).
9. Tighten all electrical connections securely.
10. Insert top module of quick-disconnection coupling into the connection box and install the two connection screws.
11. Apply a small amount of lubricant to the luminaire metric thread.
12. Thread luminaire assembly completely into the connection box of the CMB mounting module.
13. Lock mounting module with locking pin, tighten set screw.

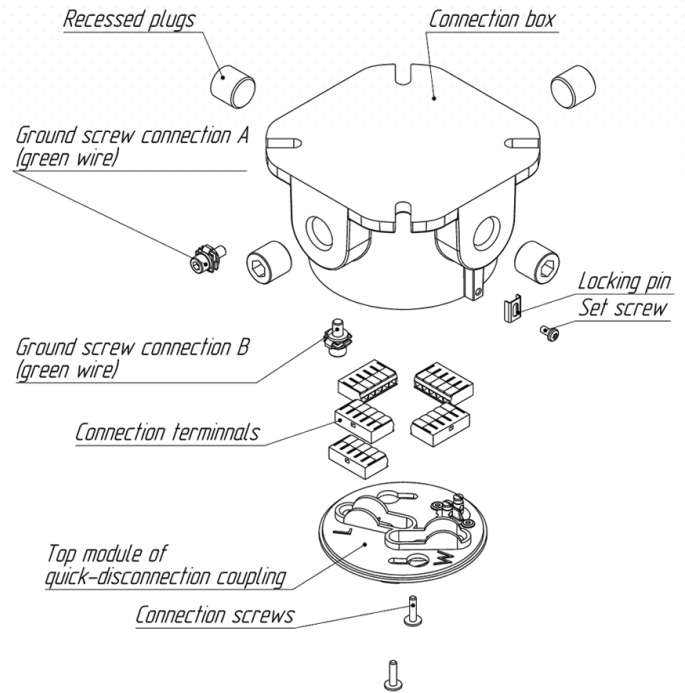

CM MOUNTING MODULE  
FIG. 14

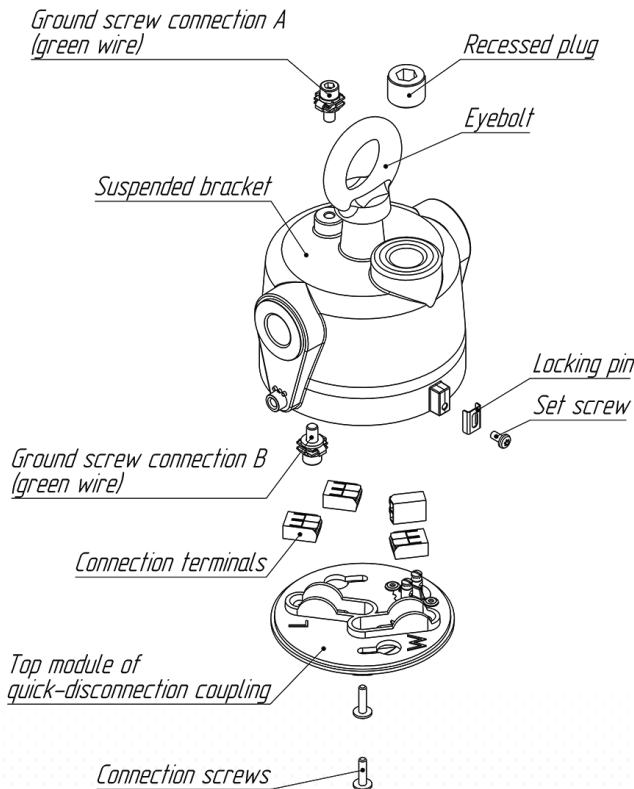

EMB MOUNTING MODULE  
FIG. 15

## EMB MOUNTING MODULE INSTALLATION:

(See Figure 15 and 9, 10, 11) (Suspended mounting)

1. Remove the recessed plug from the EMB mounting module, by using hex key 14 mm, 0,55".
2. Mount the EMB mounting module by using eyebolt.
3. Remove the top module of quick-disconnection coupling from the suspended bracket by loosening two connection screws.
4. Pull field wiring into the suspended bracket.
5. Attach circuit GREEN ground wire to ground screw connection B inside the suspended bracket and then attach outer GREEN ground wire to ground screw connection A outside the suspended bracket.
6. Attach ungrounded primary supply wire to connection terminal, which attached to BLACK wire, other supply wire to connection terminal, which attached to WHITE wire.
7. Attach POSITIVE diming wire to connection terminal, which marked with red label, and NEGATIVE diming wire to connection terminal, which marked with blue label. (If you need this function).
8. Tighten all electrical connections securely
9. Insert top module of quick-disconnection coupling into the suspended bracket, and install the two connection screws.
10. Apply a small amount of lubricant to the luminaire metric thread.
11. Thread luminaire assembly completely into the EMB mounting module.
12. Lock luminaire with locking pin, tighten set screw.

## SBB MOUNTING MODULE INSTALLATION:

(See Figure 16 and 9, 10, 11) (Wall mounting)

1. Use swivel bracket as a template, mark and drill desired location on mounting surface.
2. Secure the swivel bracket to surface using M6 bolts or lag screws (not provided).
3. Install suspended bracket inside the swivel bracket.
4. Thread screw connections.
5. To make final adjustment, loosen the pivot and locking screws to position at the desired angle.
6. Tighten the two screw connections.
7. Remove the necessary recessed plugs from suspended bracket, by using hex key 14 mm, 0,55".
8. Pull field wiring into the suspended bracket.
9. Attach circuit GREEN ground wire to ground screw connection B inside the suspended bracket and then attach outer GREEN ground wire to ground screw connection A outside the suspended bracket.
10. Remove the top module of quick-disconnection coupling from the suspended bracket by loosening two screws.
11. Attach ungrounded primary supply wire to connection terminal, which attached to BLACK wire, other supply wire to connection terminal, which attached to WHITE wire.
12. Attach POSITIVE diming wire to connection terminal, which marked with red label, and NEGATIVE diming wire to connection terminal, which marked with blue label. (If you need this function).
13. Tighten all electrical connections securely.
14. Insert top module of quick-disconnection coupling into the suspended bracket and install the two connection screws.
15. Apply a small amount of lubricant to the luminaire metric thread.
16. Thread luminaire assembly completely into the suspended bracket of the SBB mounting module.
17. Lock mounting module with locking pin, tighten set screw.

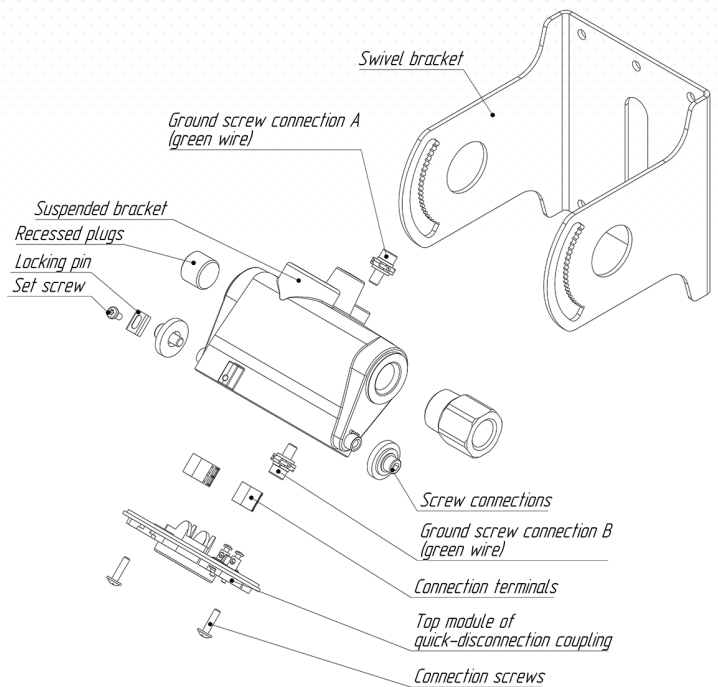

SBB MOUNTING MODULE  
FIG. 16

## MAINTENANCE

- 1 Perform visual, electrical, and mechanical inspections on a regular basis. The environment and frequency of use should determine this. However, it is recommended that checks be made at least once a year. We recommend an Electrical Preventive Maintenance Program as described in the National Fire Protection Association Bulletin NFPA No. 70B: Recommended Practice For Electrical Equipment Maintenance ([www.nfpa.org](http://www.nfpa.org)).
- 2 The lens should be cleaned periodically to ensure continued lighting performance. To clean, wipe the lens with a clean, damp cloth. If this is not sufficient, use a mild soap or a liquid cleaner. Do not use an abrasive, strong alkaline, or acid cleaner. Damage may result.
- 3 Visually check for undue heating evidenced by discoloration of wires or other components, damaged parts, or leakage evidenced by water or corrosion in the interior. Replace all worn, damaged, or malfunctioning components, and clean gasket seals before putting the luminaire back into service.
- 4 Electrically check to make sure that all connections are clean and tight.
- 5 Mechanically check that all parts are properly assembled.
- 6 To prevent heat build-up, remove dust from the fins on the LED housing, using a soft brush or air pressure.



## CABLE INSTALLATION INTO THE CID1 OR CID2 CABLE GLAND

1. Untighten the outer seal nut
2. Prepare size range 12 - 18 AWG cable wires for connecting to the fixture terminals by stripping back few millimeters of each wire sheath to suite the terminal geometry. (NOTE! 12 AWG is the maximum wire diameter to be used with the device terminals)
3. Pass the size range 12-18 AWG cable through the cable gland inside the enclosure. (NOTE! If other size cables are required different CID1 or CID2 cable gland/grip can be used with appropriate ADAPTER to CABLE GLAND IP66 sealing)
4. Connect the wires to the fixture terminals.
5. Tighten the outer seal nut. (NOTE! Make sure all the components – adapter, sealing nut, cable grips are well tightened)

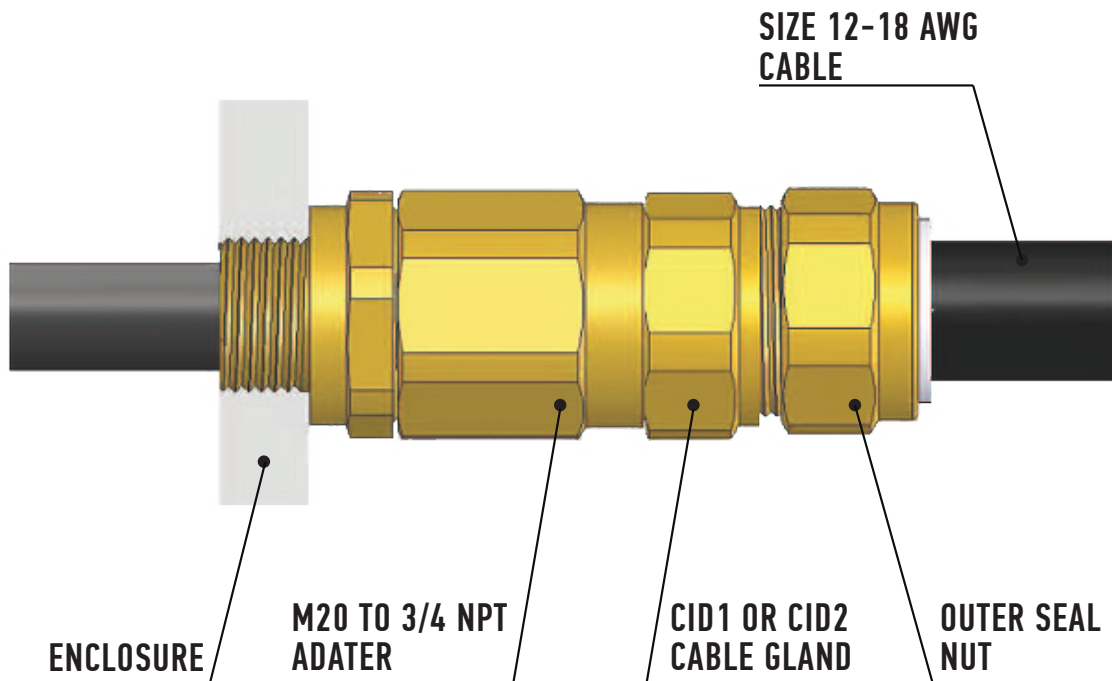

## CONTACTS

**(858) 353-1073**

[SALES@ARCUSLIGHT.COM](mailto:SALES@ARCUSLIGHT.COM)

PO BOX 3097,  
RANCHO SANTA FE, CA 92067